

**JK798**

**User Guide**

**产品使用说明书**

**杰克缝纫机**  
JACK SEWING MACHINE

| JACK HOLDING GROUP | [WWW.JACKGROUP.COM.CN](http://WWW.JACKGROUP.COM.CN) |

Handwritten signature: 4 M 800

## 1 机壳机构

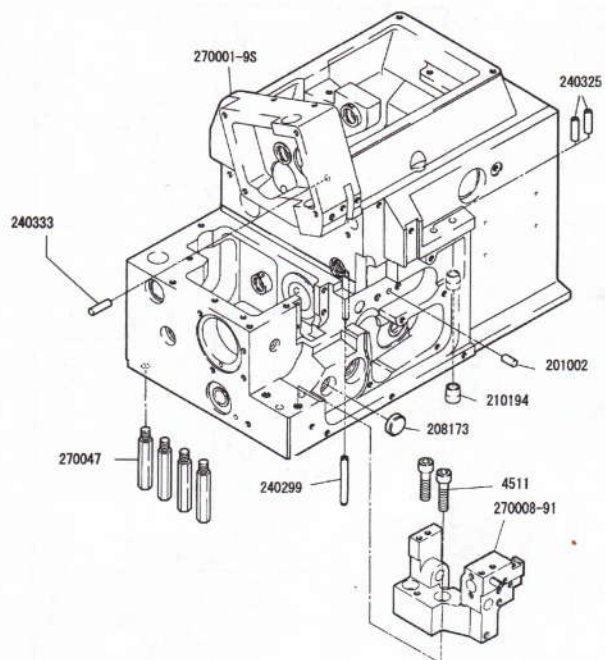

## 2 外罩机构(1)

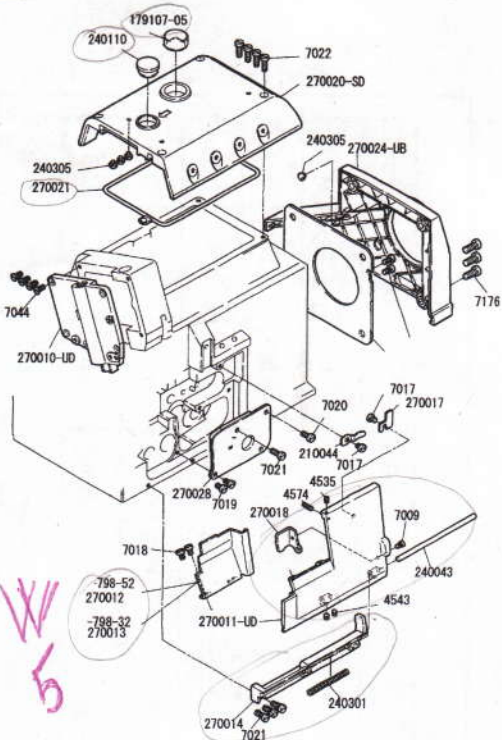

### 3 外罩机构(2)

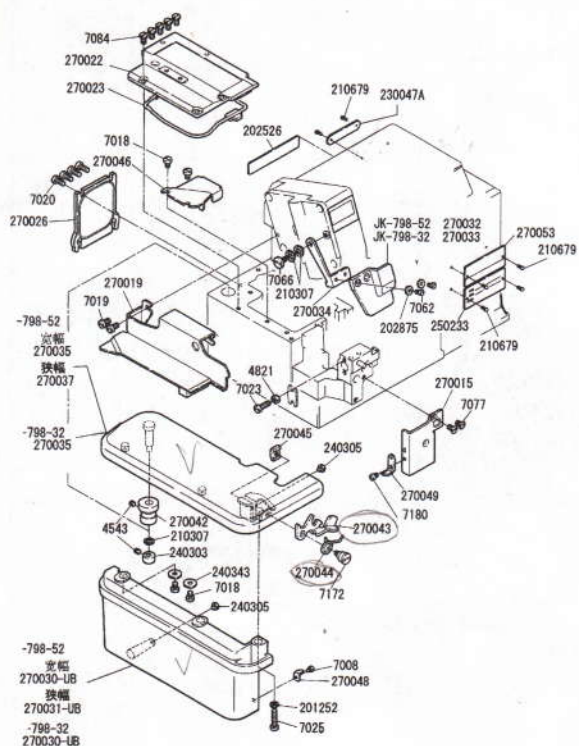

#### 4 主轴机构

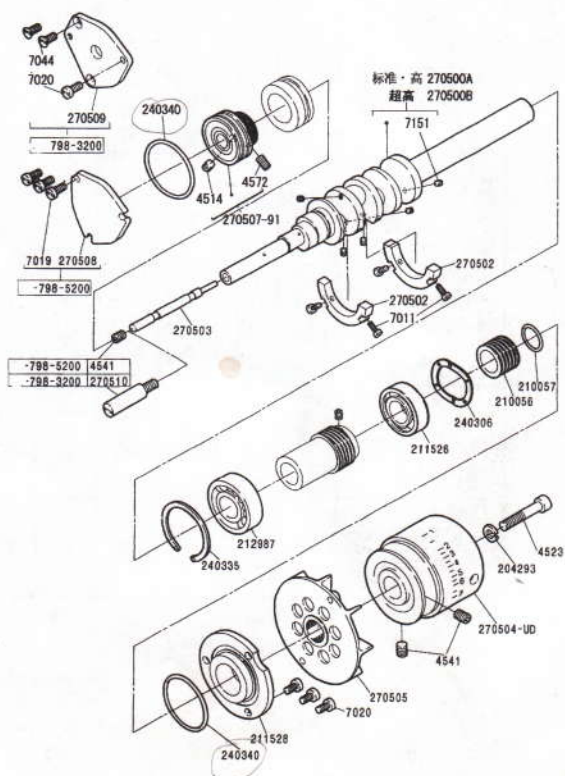



## 5 调线机构

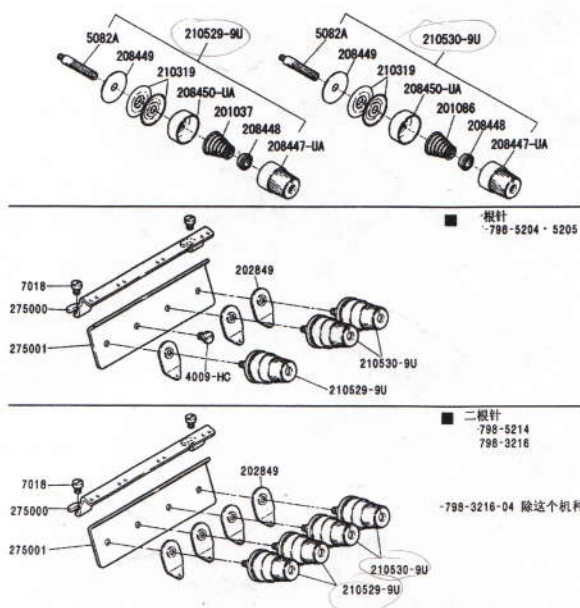

## 7 挑线·过线(2)

798-5200

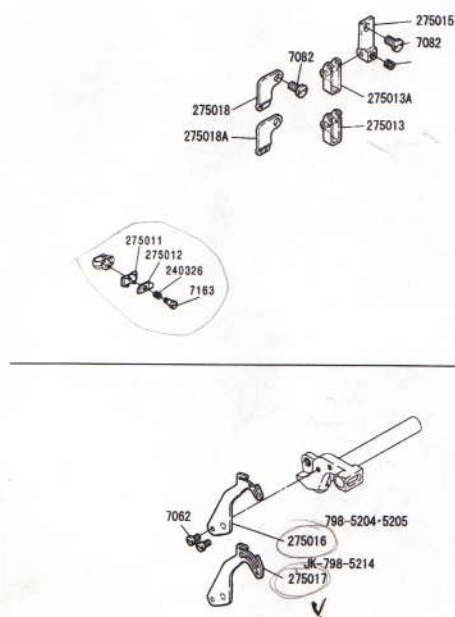

## 6 挑线·过线

**-798-3200**

■ 二根針  
798-3216

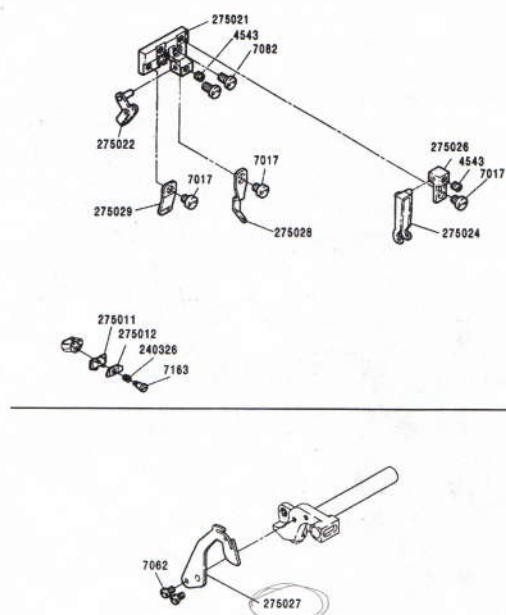

## 8 挑线·过线(3)

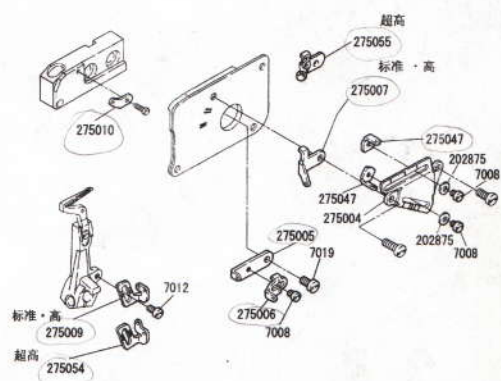

## 9 针棒机构(1)

G 参照标准度量

798-3200

798-5200

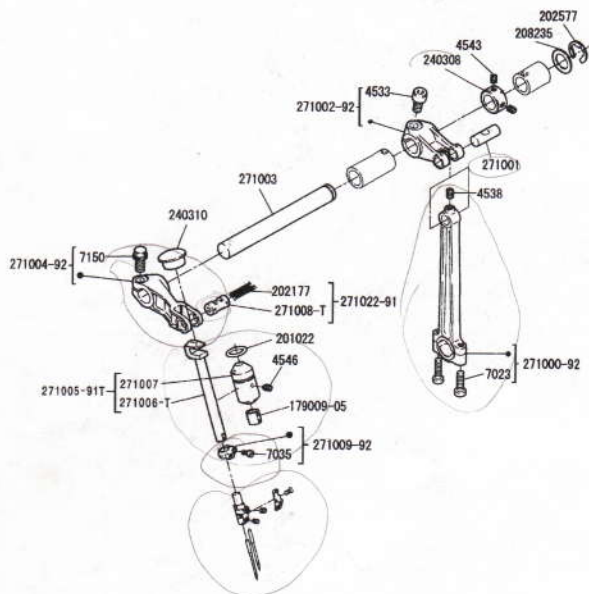

## 10 针棒机构(2)

798-3200

G 参照标准度量

■ 2根针  
798-3216

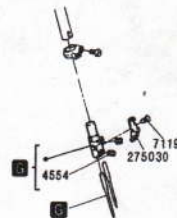

798-5200

■ 1根针

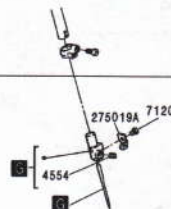

■ 2根针

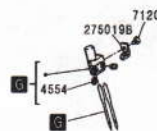

## 11 针棒机构(3)

798-3200

G 参照标准度量

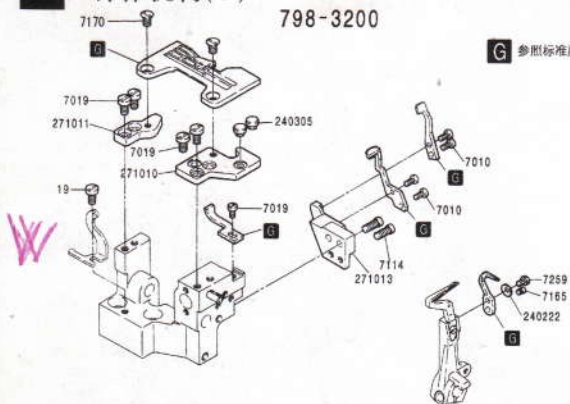

798-5200

G 参照标准度量

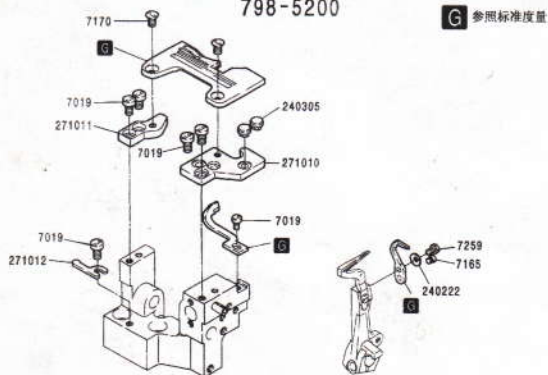

## 12 上弯针机构

798-3200  
798-5200

G 参照标准度量

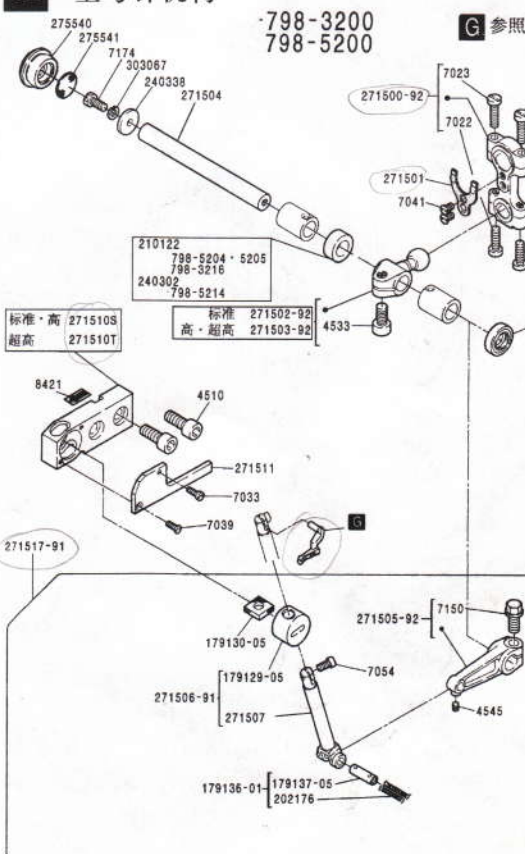





## 17 送布机构(2)

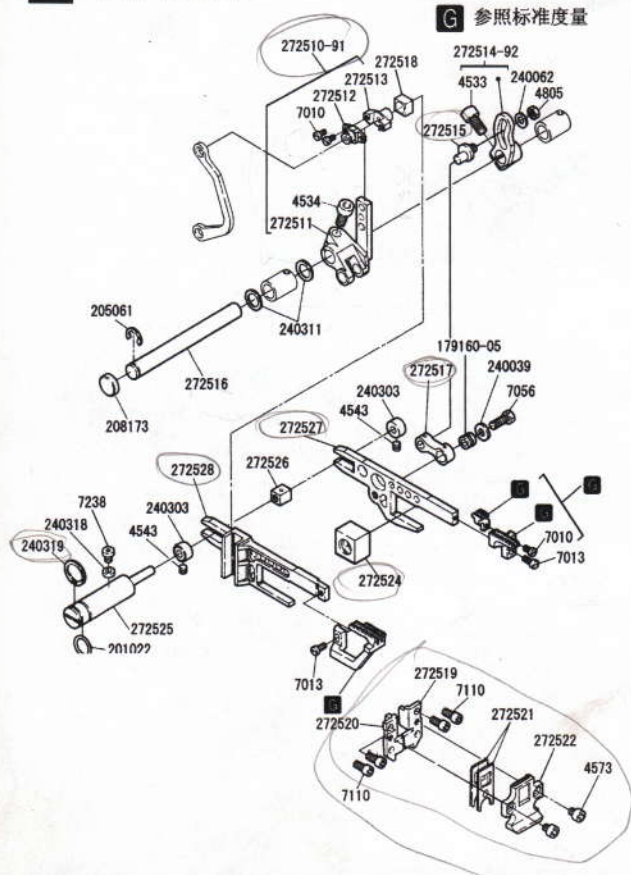

## 18 上下刀机构

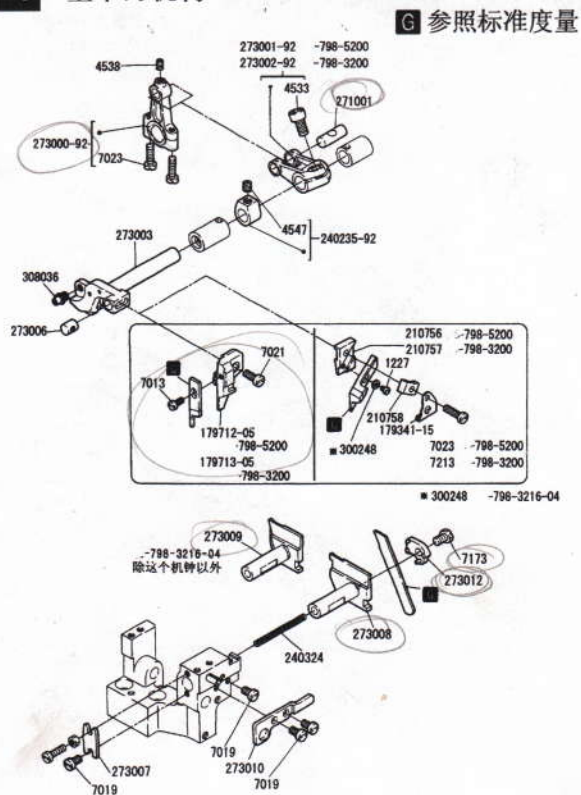

## 19 压脚机构

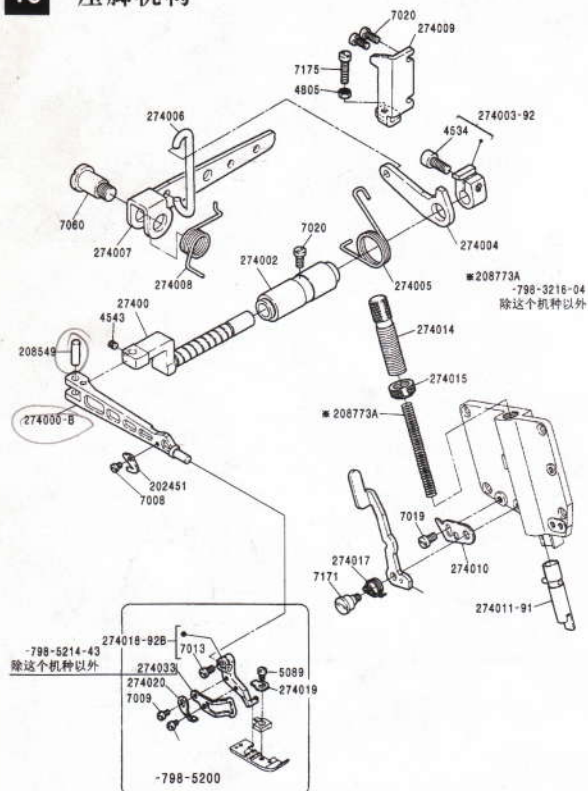

## 20 供油机构(1)

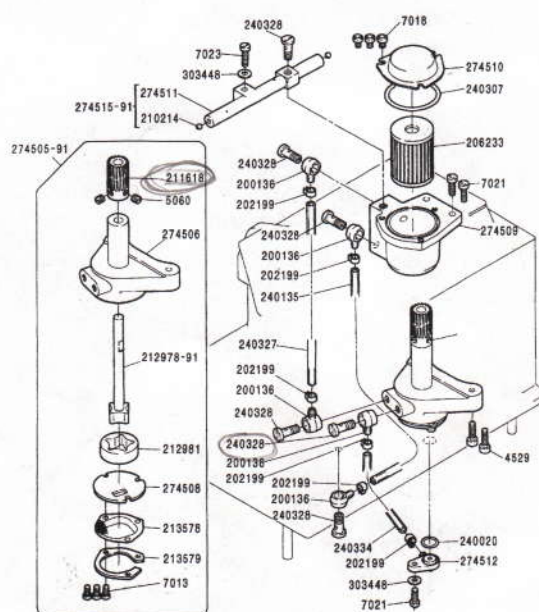

## 21 供油机构(2)

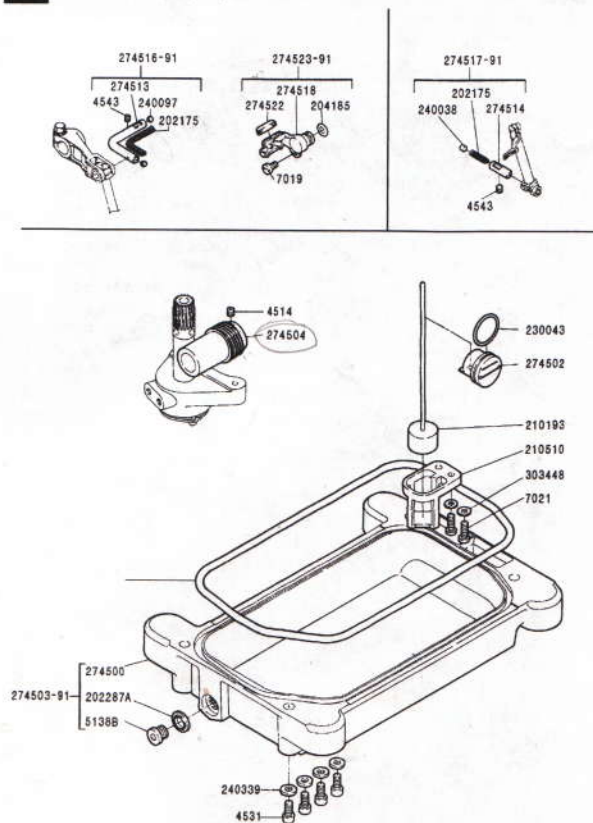

## 22 H·R装置

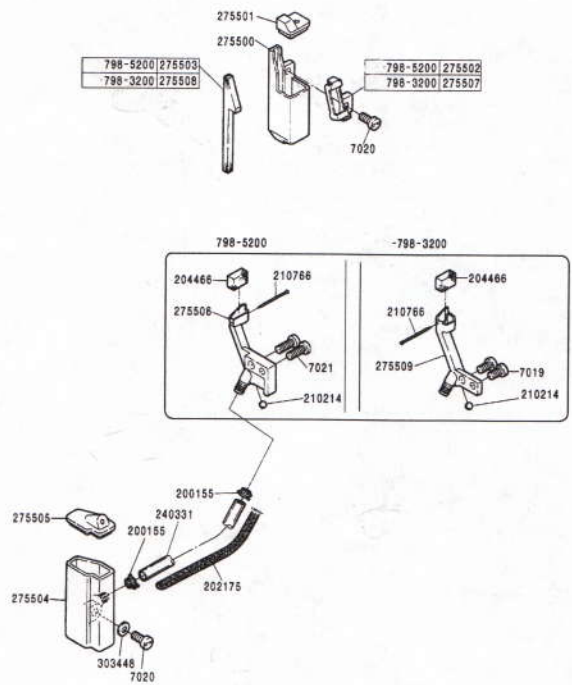

## 23 线架

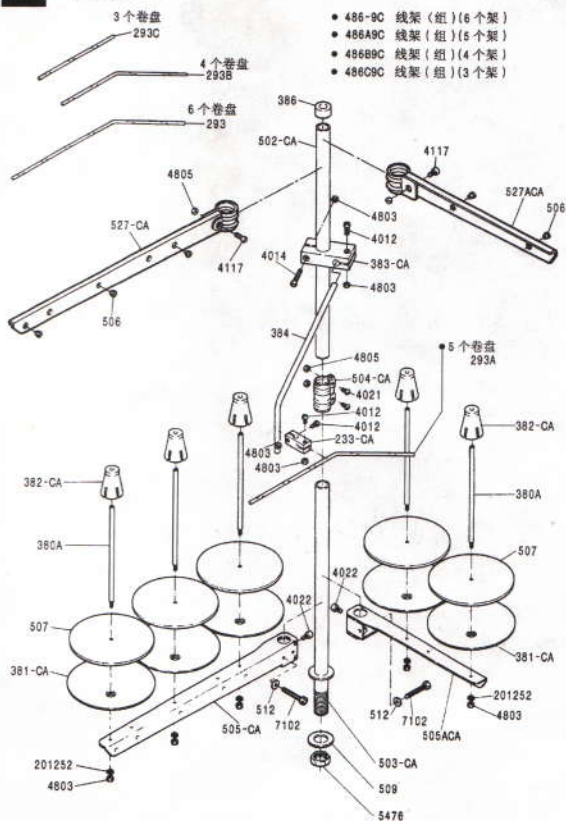

## 24 油盘托架

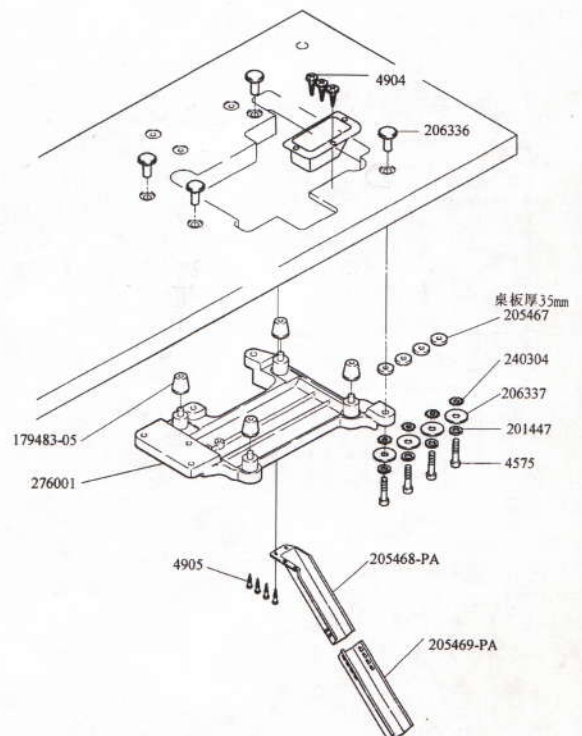



## 25 专用零件(1)一般缝

G 参照标准度量

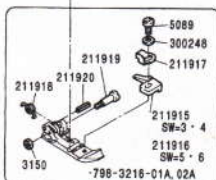
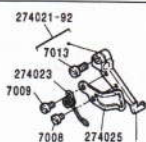
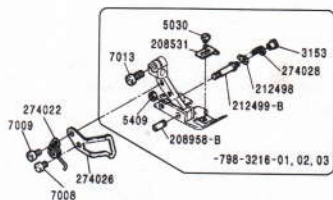
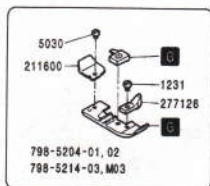

## 26 专用零件(2)一般缝

G 参照标准度量

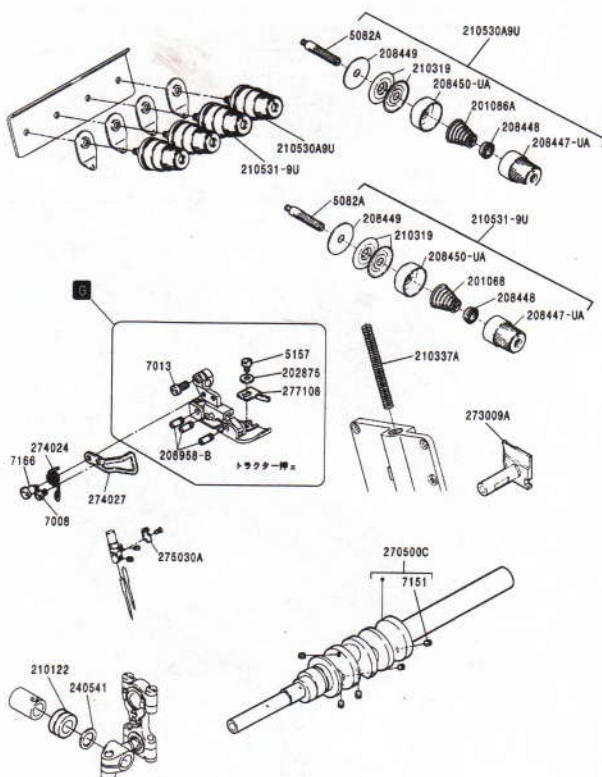

## 27 专用零件(3)下摆卷边

G 参照标准度量

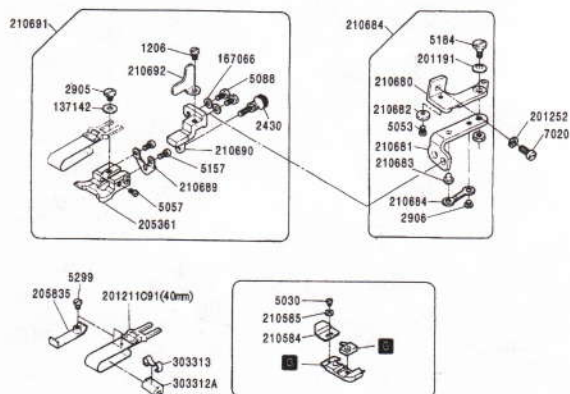

## 28 专用零件(4)布料包边

G 参照标准度量

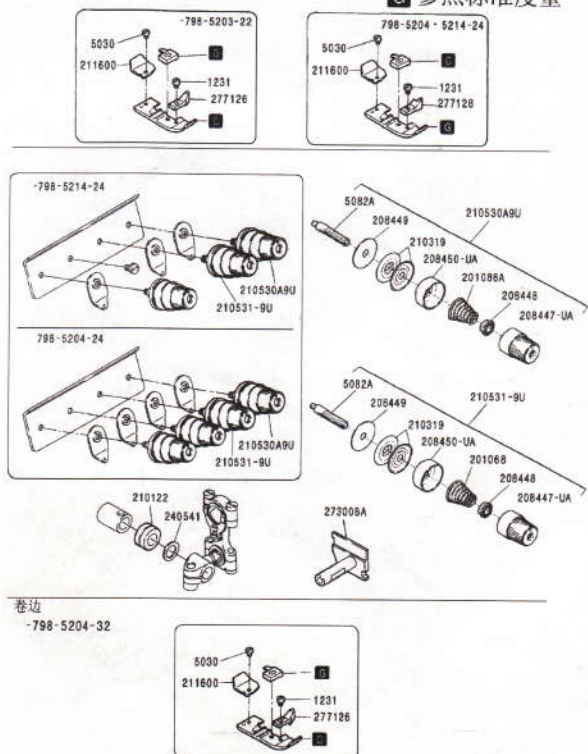





### 33 倒回缝

#### G 参照标准度量

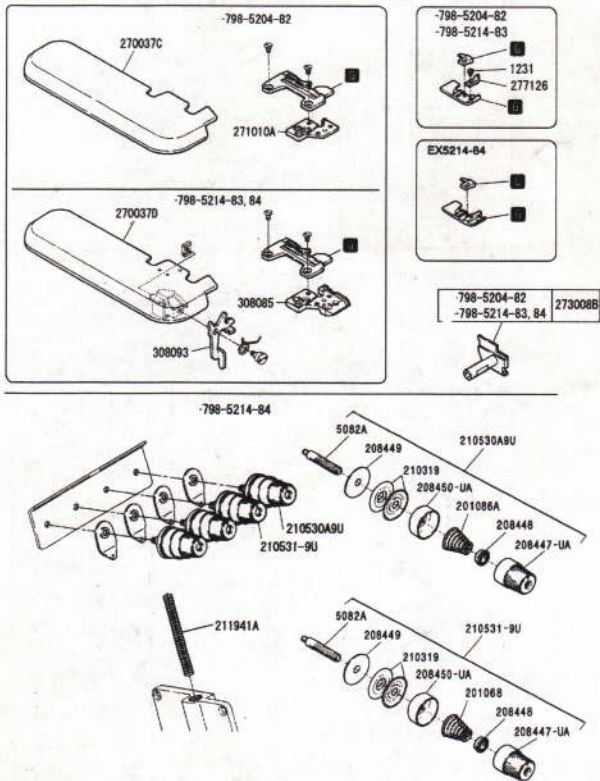

### 34 挡布导向

选择

798-5203-22  
798-5204-01, 02, 24, 32  
798-5214-01, 03, M03, 53, M53

-798-3216-01, 01A, 02, 02A, 03, A04

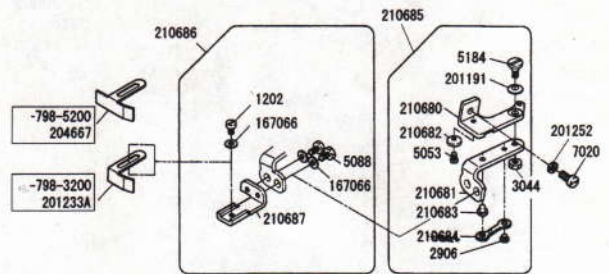



798-5200 标准度量零件表

型号	间距		针板	主送布牙组件		主送布牙	辅送布牙		差动送布牙	压脚组件	压脚爪	上弯针	下弯针
	GAUGE			MAIN FEED			AUX.FEED						
MACHINE TYPE /SPEC.	NG	SW	NEEDLE PLATE	MAIN FEED DOG ASS.	MAIN FEED DOG		DOG	DOG	DOG	PRESSER FOOT ASS.	UPPER LOOPER	LOWER LOOPER	CHAINSTITCH LOOPER
798-5204-02/233		4	277504R40	277303-16F	277304-16F		277318-13	277305-16F	277305-16F	201230C	210371 #2	277010 #2	277015
798-5205-12/223		4	277500P40	277300-16F	277301-16F		277318-13	277302-16F	277302-16F	201152E	277103 #11	277010 #2	277015
798-5214-03/333	2	4	277505R40	277303-16F	277304-16F		277318-13	277305-16F	277305-16F	201230C	210374 #7	277010A #5	277015
798-5214-43P2/333	2	4	277505R40	277306-16	277307-16		277318-13	277308-16	277308-16	277125		277010A #5	277015
798-5214-M53/333	2	4	277505R40	277303-16F	277304-16F		277318-13	277305-16F	277305-16F	277112	208651	277010A #5	277034
798-5214-54/433	2	4	277505R40	277303-16F	277304-16F		277318-13	277316-16F	277316-16F	277112	208651	277011 #3	277015
798-5214-54/443	2	4	277507R40	277351-16F	277352-16		277318-13	277353-16F	277353-16F	277111	277104 #16	277011 #3	277015
798-5204-32R2/223		1.5	277512P15	277315-16F	277301-16F		277319-13	277302-16F	277302-16F	202799	205525	277010 #2	277015

型号 MACHINE TYPE /SPEC.	间距		上刀			下刀 LOWER KNIFE	可移动护针架		针夹 NEEDLE HOLDER	针夹过线 THREAD GUIDE (NDL HOLDER)	针 NEEDLE	
			GAUGE	NG	SW		平刀					角刀
	UPPER KNIFE	FLAT KNIFE					ANGLED KNIFE					
								FRONT				
798-5204-02/233		4		201121A	210755	202295	277005	277004	179630-92	275019A	DCX27 #9	
798-5205-12/223		4		201121A	210755	202295	277005	277004	179630-92	275019A	DCX27 #9	
798-5214-03/333	2	4		201121A	210755	202295	277005	277004	277022-92	275019B	DCX27 #9	
798-5214-43P2/333	2	4		201121A	210755	202295	277005	277004	277022-92	275019B	DCX27 #11	
798-5214-M53/333	2	4		201121A	210755	202295	277005	277004	277022-92	275019B	DCX27 #9	
798-5214-54/433	2	4		201121A	210755	202295	277005	277004	277022-92	275019B	DCX27 #11	
798-5214-54/443	2	4		201121A	210755	202295	277005	277004	277022-92	275019B	DCX27 #11	
798-5204-32R2/223		1.5		201121A	210755	202295	277005	277004	179630-92	275019A	DCX27 #11	

798-3216 标准度量零件表

型号	MACHINE TYPE /SPEC.	间距		针板	主送布牙组件		主送布牙	辅送布牙	差动送布牙	压脚组件	上弯针	下弯针	连线弯针
		NG	SW		MAIN FEED DOG ASS.	MAIN FEED DOG							
798-3216-02A/223		3	4	277513R40	277323-16	277324-16	277318-13	277325-16	277325-16	211909	277010 #2	277015	277018
798-3216-03/233		3	4	277517R40	277327-16	277328-16	277318-13	277330-16	277330-16	277118	277010 #5	277015	277018
798-3216-03/333		5	5	277516R50	277327-16	277328-16	277318-13	277329-16	277329-16	277119	277010 #2	277015	277018
798-3216-04/435		5	6	277524T60	277337-25	277338-25	277318-13	277339-25	277339-25	277122	277011 #3	277015	277018-C
798-3216-42/233		3	4	277521R40	277334-16	277335-16	277318-13	277336-16	277336-16	277120	277010A #5	277015	277018

型号	MACHINE TYPE /SPEC.	间距		上刀		下刀	可移动护针架		全连线护针架		针夹	针夹过线	针
		NG	SW	平刀	角刀		前	后	前	后			
798-3216-02A/223		3	4	202527A		202295	OVERLOCK NEEDLE GUARD FRONT	OVERLOCK NEEDLE GUARD REAR	CHAINSTITCH NEEDLE GUARD FRONT	CHAINSTITCH NEEDLE GUARD REAR	277027-92	275030	DCX27 #11
798-3216-03/233		3	4	201121A	210755	202295	277007	277007	277008	277006	277027-92	275030	DCX27 #14
798-3216-03/333		5	5	201121A	210755	202295	277007	277007	277008	277006	277028-92	275030	DCX27 #27
798-3216-04/435		5	6	277000	211862	277009	277007	277007	277008	277006	277029-92	275030A	DC-27 #21
798-3216-42/233		3	4	201121A	210755	202295	277007	277007	277008	277006	277027-92	275030	DCX27 #14